



Ingenious Quality Intelligent Medical



ASIAMEDIC HOSPITAL SUPPLY SDN BHD

G07, Pangsapuri Oren 3, Jalan Pantai Bersih, Taman Pantai Bersih, 13000,
Butterworth, Pulau Pinang. TEL-Phone: 012-B25 277B
Mailbox: info@asiamedic.com.my



LATEX-FREE STERILE EO



Closed Suction System Single Lumen 72 H

Double Swivel Elbow & Push Switch

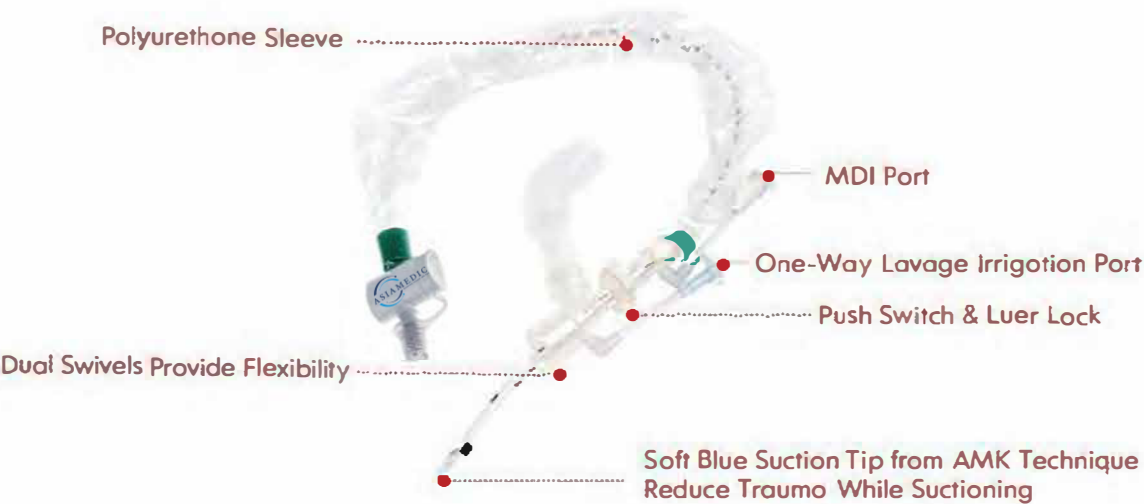

DISPOSABLE CLOSED SUCTION CATHETERS 72 HOURS

- The smart design of the Closed Suction Catheters allows the patients' breath-mechanical ventilation and suctioning simultaneously.
- Push switch and Luer lock. This design can keep breathing and isolate the turbulent cleaning chamber, and prevent spray back, which reduces the risk of VAP (ventilator-associated pneumonia) for ventilated patients.
- Prevent cross infection. The closed suction systems are designed with protective sleeve to isolate the germs inside the patients and help caregivers avoid cross infection.
- Soft and smooth blue suction tip. This design reduces damage to mucous membranes.
- Double swivel connectors reduce strain on ventilator tubing.
- Easy operation in suction process by being equipped with a wedge (separator) to disconnect and clip functions.
- Available for tracheostomy tubes. The suction catheters match tracheostomy tubes, of which different lengths are available. The catheters are marked with accurate depth to understand the proper catheter insertion in the trachea.
- The design of push switch and Luer lock can reduce the risk of VAP for ventilated patients.

Product Code	Size	Colour Code	Tube OD (mm)	Length of Tube (mm)
AMHS- 272101	Adult/72H/Tracheostomy	Black	10Fr (3.35mm)	300mm
AMHS- 272121	Adult/72H/Tracheostomy	White	12Fr (4.05mm)	300mm
AMHS- 272141	Adult/72H/Tracheostomy	Green	14Fr (4.75mm)	300mm
AMHS- 272161	Adult/72H/Tracheostomy	Orange	16Fr (5.45mm)	300mm
AMHS- 272100	Adult/72H/Endotracheal	Black	10Fr (3.35mm)	600mm
AMHS- 272120	Adult/72H/Endotracheal	White	12Fr (4.05mm)	600mm
AMHS- 272140	Adult/72H/Endotracheal	Green	14Fr (4.75mm)	600mm
AMHS- 272160	Adult/72H/Endotracheal	Orange	16Fr (5.45mm)	600mm

Closed Suction System Single Lumen 24 H

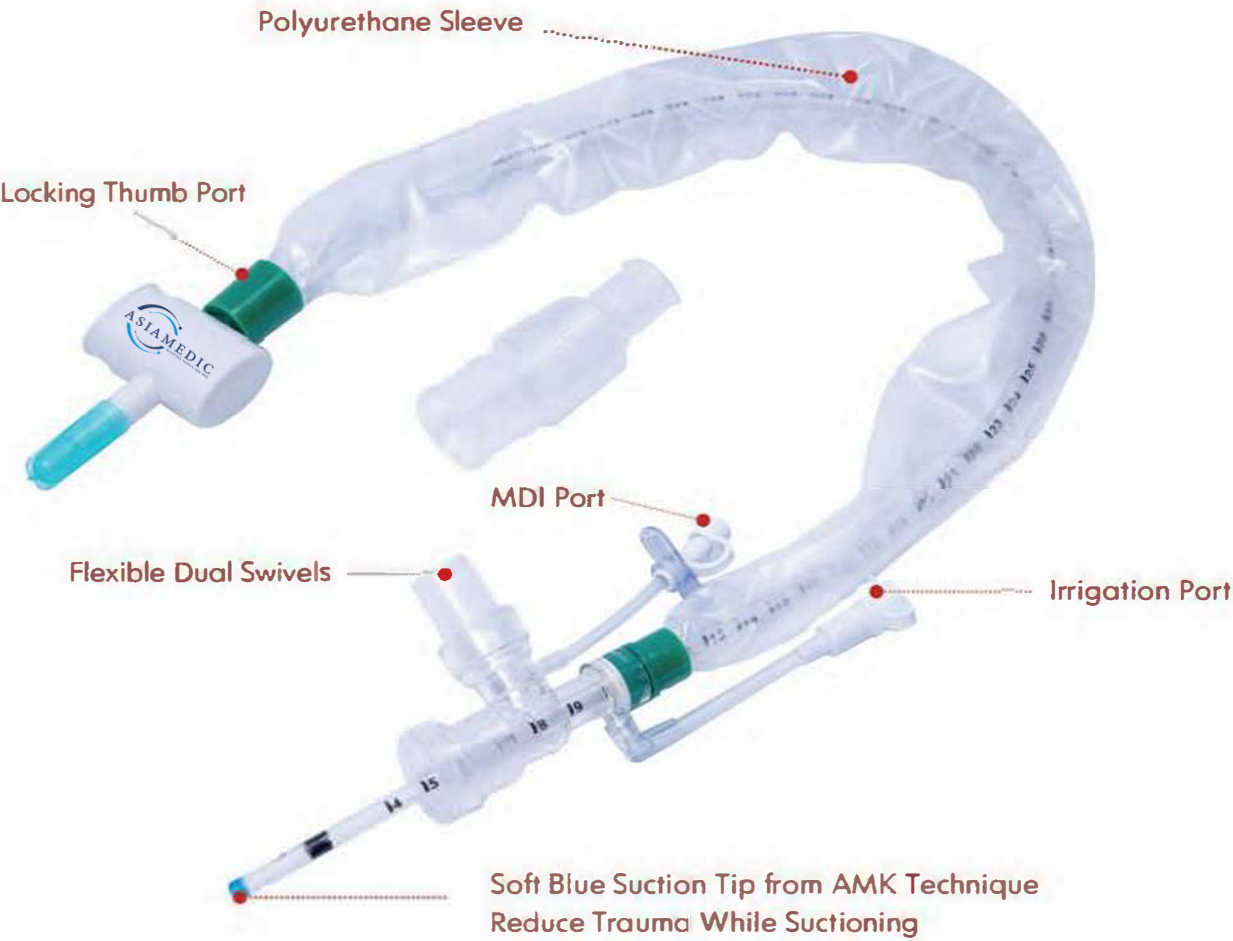

- ❑ The Closed Suction Catheter is a suctioning device to remove secretions from patients receiving mechanical ventilation.
- ❑ Soft and smooth blue suction tip. This design reduces damage to mucous membranes.
- ❑ Allow the patients' breath-mechanical ventilation and suctioning simultaneously.
- ❑ Prevent cross infection. The PU protective sleeve can protect the caregivers from infection.
- ❑ Double swivel connectors reduce strain on ventilator tubing.
- ❑ Easy operation in suction process by being equipped with a wedge to disconnect and clip functions.
- ❑ Available for tracheostomy tubes. The suction catheters match tracheostomy tubes, of which different lengths are available. The catheters are marked with accurate depth to understand the proper catheter insertion in the tracheal.
- ❑ Color coded rings provide fast recognition.

Product Code	Size	Colour Code	Tube OD (mm)	Length of Tube (mm)
AMHS	Neonatal/24H/Tracheostomy	Grey	5Fr (1.7mm)	300mm
AMHS	Neonatal/24H/Tracheostomy	Light Green	6Fr (1.95mm)	300mm
AMHS	Pediatric/24H/Tracheostomy	Ivory	7Fr (2.3mm)	300mm
AMHS	Pediatric/24H/Tracheostomy	Light Blue	8Fr (2.7mm)	300mm
AMHS- 124101	Adult/24H/Tracheostomy	Black	10Fr (3.35mm)	300mm
AMHS- 124121	Adult/24H/Tracheostomy	White	12Fr (4.05mm)	300mm
AMHS- 124141	Adult/24H/Tracheostomy	Green	14Fr (4.75mm)	300mm
AMHS- 124161	Adult/24H/Tracheostomy	Orange	16Fr (5.45mm)	300mm
AMHS- 024050	Neonatal/24H/Endotracheal	Grey	5Fr (1.7mm)	300mm
AMHS- 024060	Neonatal/24H/Endotracheal	Light Green	6Fr (1.95mm)	300mm
AMHS- 024070	Pediatric/24H/Endotracheal	Ivory	7Fr (2.3mm)	300mm
AMHS- 024080	Pediatric/24H/Endotracheal	Light Blue	8Fr (2.7mm)	300mm
AMHS- 124100	Adult/24H/Endotracheal	Black	10Fr (3.35mm)	600mm
AMHS- 124120	Adult/24H/Endotracheal	White	12Fr (4.05mm)	600mm
AMHS- 124140	Adult/24H/Endotracheal	Green	14Fr (4.75mm)	600mm
AMHS- 124160	Adult/24H/Endotracheal	Orange	16Fr (5.45mm)	600mm

Closed Suction System Child Type 24 H

- ❑ DISPOSABLE PEDIATRIC CLOSED SUCTION CATHETERS 24 HOURS
- ❑ The smart design of the Closed Suction Catheters allows the patients' breath-mechanical ventilation and suctioning simultaneously.
- ❑ Y connector type. ET "Y" neonatal and pediatric care adaptors are available for 5, 6, 7, 8, French sizes closed suction catheter.
- ❑ Prevent cross infection. The closed suction systems are designed with protective sleeve to isolate the germs inside the patients and help caregivers avoid cross infection.
- ❑ Soft and smooth blue suction tip. This design reduces damage to mucous membranes.
- ❑ Irrigation port with non-return valve which prevents back flow leakage during washing and aerosolized secretion contamination.

Closed Suction System Child Type 24 H

Available for tracheostomy tubes. The suction catheters match different sizes of endotracheal tubes. The catheters are marked with accurate depth to understand the proper catheter insertion in the trachea.



Closed Suction System Child Type 24 H

Product Code	Size	Colour Code	Tube OD (mm)	Length of Tube (mm)
AMHS	Neonatal/24H	Grey	5Fr (1.7mm)	300mm
AMHS	Neonatal/24H	Light Green	6Fr (1.95mm)	300mm
AMHS	Pediatric/24H	Ivory	7Fr (2.3mm)	300mm
AMHS	Pediatric/24H	Light Blue	8Fr (2.7mm)	300mm
AMHS	Pediatric & Child/24H	Black	10Fr (3.35mm)	400mm
AMHS	Big Child/24H	White	12Fr (4.05mm)	400mm

Instructions for Use

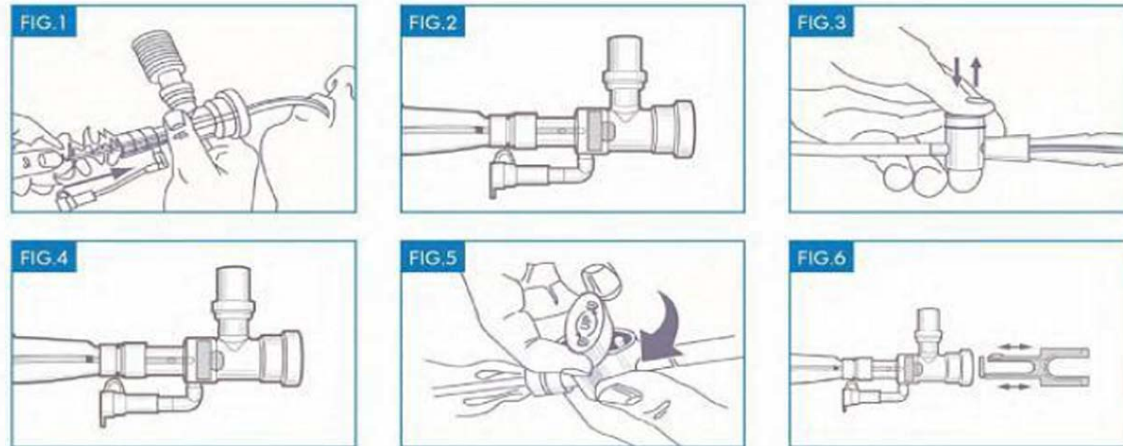

Setup:

- 1 Select appropriate size catheter.
- 2 Attach thumb control valve to suction tubing.
- 3 Depress and hold thumb valve and simultaneously adjust vacuum regulator to desired level.
- 4 Release thumb control valve and attach catheter between patient and the ventilator circuit.

Suggested Suction Procedure:

- 1 Stabilize catheter and endotracheal (ET) adapter with one hand then push the catheter into the endotracheal tube with the thumb and forefinger of the opposite hand (Fig1)
- 2 Advance catheter to desired depth.
- 3 Depress and hold thumb control valve, then gently withdraw catheter. Stop withdrawal when black marking ring is visible inside sleeve (Fig2)
- 4 Release thumb control valve .
- 5 Instill desired amount of fluid by syringe (other flush infusion set) into the irrigation port. Depress and hold thumb control valve while flushing.
- 6 After flushing the tube tip, remove syringe and close the cap on the irrigation port.
- 7 Repeat steps 1 through 6 above as necessary.
- 8 It is intended to be used for 72 hours before changing. Change more frequently if catheter becomes heavily soiled during use.
- 9 The maximum sputum suction pressure for adults does not exceed 150mmHg, and the sputum suction pressure for infants and children is 80-100mmHg. The actual sputum suction time is recommended not to exceed 15s.

Patient Lavage Instructions:

- 1 For intubated patient, advance catheter 10-13cm (4-5 inches) into the endotracheal tube. For tracheostomy patient, advance the catheter 3-4 cm (1.5-2 inches) into the tracheostomy tube.
- 2 Advance the catheter to desired depth and follow the above suggested suction procedure.

Catheter Irrigation Instruction:

- 1 Be sure the black-marked ring is visible in the sleeve (Fig 2). Open the cap on the irrigation port.
- 2 Insert a syringe into the irrigation port and release your hand.
- 3 Depress the thumb control valve (Fig3) until the catheter and chamber are clear (Fig4).
- 4 Remove the syringe and close the cap on the irrigation port.
- 5 Lift and turn the thumb control valve 180 degrees to lock position (Fig5)
- 6 Place catheter and suction tubing alongside breathing circuit.

Tracheostomy Patients:

- 1 Use tracheostomy 30cm (12 inch) catheters for patients with tracheostomy artificial airway only. If 30cm catheter is used on endotracheal artificial airway, ineffective suction may result.
- 2 Do not use 60cm (23.6 inch) catheters on tracheostomy patients. Mucosal damage may result.

Control Depth Suction (For catheters with numerical markings only)

- 1 Align any printed depth number on the catheter with the similar number printed on the endotracheal tube, or observe the printed number on the endotracheal tube closest to the endotracheal tube adapter.
- 2 Add 6 cm to this number.
- 2 Advance catheter until the sum (depth plus 6) appears in the window directly across from irrigation port connector.
- 4 The catheter tip will be within 1 cm of the end of the artificial airway.

Thumb Control Valve Operation:

The thumb control valve can be locked to prevent inadvertent or accidental suction. To lock, lift white part of thumb control valve and rotate 180 degrees. To unlock, repeat this action (Fig5).